

## BALL BEARINGS WITH PLASTIC BLOCK

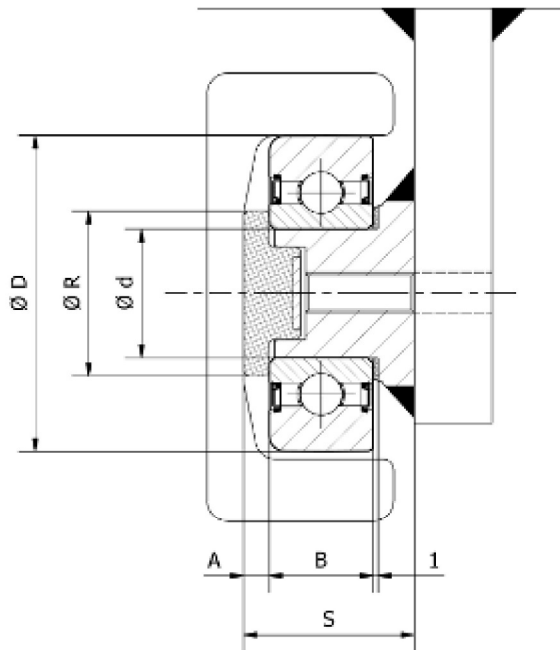

<b>MATERIAL</b>	
External rings	STEEL UNI 17MnCr5/ DIN 17MnCr5/ WNr.1.3521 (CTRs 58÷60HRc)
Interior rings	STEEL UNI 100Cr6/ DIN 100Cr6/ WNr.1.3505 (TRs 60÷62 HRc)
Ball bearing	STEEL UNI 100Cr6/ DIN 100Cr6/ WNr.1.3505 (TRs 61÷63 HRc)
Disk	POLIAMYD "ERTALON"66 SAMU
Pin	UNI Fe510.C/DIN St 52.3/ WNr. 1.0553

	Size							Elements						Baric. mm.	Capacity KN	Section Type
	GROUP CODE	d mm.	D mm.	B mm.	S <sub>max</sub> mm.	S <sub>min</sub> mm.	R mm.	A mm.	Bearing	Pin	Lateral disk	Disk of contrast	Registration ring			
10000	25	52,4	17	28	27	32	6	MRS 900	10000.101	10001.102	10001.103	AS.02505	M10X16	300	2÷4	EC053
10001	25	62,4	20	33	31	32	5	MRS 948	10001.101	10001.102	10001.103	AS.02505	M10X16	500	5÷8	EC062
10002	30	70	22	38	36	40	5	MRS 901	10002.101	10002.102	10002.103	AS.03005	M10X16	500	10÷15	EC070 ET070 ECC070
10003	30	78	22	38	36	40	5	MRS 907	10002.101	10002.102	10002.103	AS.03005	M10X16	500	15÷20	EC078 ET078 ECC078